

AUX168II

Stereo Ceiling Speaker



Description

This product is a stereo ceiling speaker for background music broadcasting. It is made of high-quality engineering plastic and designed with beautiful and classy outlook, small and exquisite terminals, completely fitting into the fashionable new classical taste of modern family. Its special configuration makes the mid frequency and high frequency be apart completely, avoiding the speaker resonance.

Features

- With 1" mylar dome tweeter with Ferrofluid liquid cooling technique for greater power handling.
- With wide scattering range.
- With a strong magnetic device and 2-phase circuit for a clear sound.
- With 6" paper cone woofer working with a butyl rubber surround.
- With two inverted-phase pipes, the woofer is provided with deep and shocking bass, rendering an immersive experience for you anytime and anywhere.

Specifications

Model	AUX168II
Driver Units	6.5"×1
Rated Power	20W
Impedance	8Ω
Frequency Response	60Hz-20,000Hz
Sensitivity	89±2dB
MAX. SPL.	102±2dB
Dimensions	Φ233×97mm
Weight	1.6kg

Front/Rear Panel

Installation

Step 1. Press to ascend the method of the diagram trumpet net the crest outs.

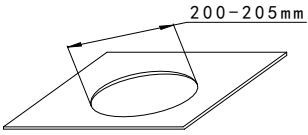

Step 2. Cut a \varnothing 200mm - \varnothing 205mm installation hole on ceiling as shown above.

Step 3. Connect public address wire to the terminals.

Step 4. Push the loudspeaker into your ceiling, beat with screw tight and install the net.

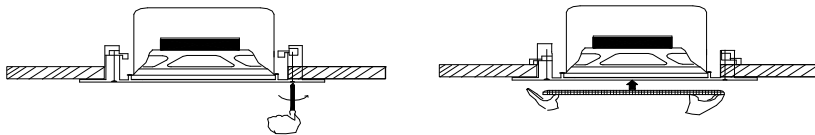

Step 5. Adjust the direction of the set and examine whether it is steady.

Frequency Response & Distortion

Frequency Response

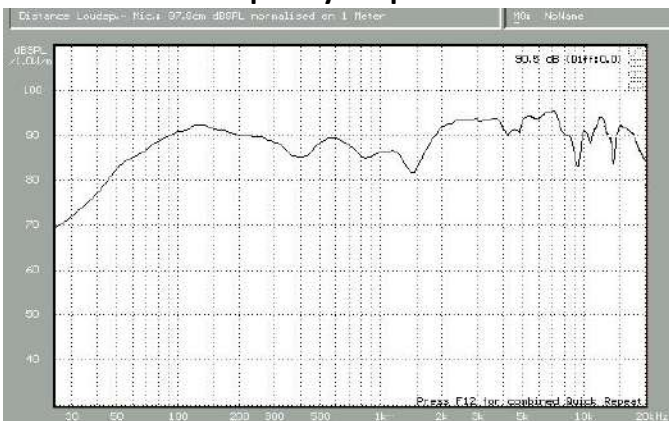

THD < 1.5% (1W, 1m, 60Hz-10kHz)

